



Compact Full-HD 1080P Dash Camera
with 3.2" IPS Screen & GPS Logger



KPT-590GPS
USER MANUAL



CONTENTS

1.0 CAUTION	4
1.1 Battery Warning	5
1.2 Product Information	7
2.0 INTRODUCTION	7
2.1 Package Contents	8
2.2 Product Overview	9
3.0 BUTTON FUNCTIONS	10
4.0 GETTING STARTED	11
4.1 Inserting a Micro SD Card	11
4.2 Removing a Micro SD Card	12
4.3 Installing the KPT-590GPS	13
4.4 Installing the KPT-590GPS Mount	14
4.5 Connecting to Power	15
4.6 LED Indicator	16

5.0	POWERING THE KPT-590GPS ON/OFF	17
5.1	Auto Power ON/OFF.....	17
5.2	Manual Power ON.....	17
5.3	Manual Power OFF	17
5.4	Re-setting the Dash Camera.....	17
6.0	INITIAL SETTINGS	18
6.1	Formatting the Inserted Micro SD Card.....	18
7.0	SETTING THE TIME AND DATE	19
8.0	VIDEO MODE	20
9.0	INTERFACE	21
9.1	Video Mode.....	21
9.2	Setup Menu	22
10.0	VIDEO MENU	23
11.0	PICTURE MODE	28
12.0	PLAYBACK	29

13.0	SOFTWARE PLAYBACK	30
14.0	WARRANTY TERMS & CONDITIONS	31
14.1	Indemnity	32
14.2	Warranty and Warranty Disclaimer	32
15.0	NOTES	35

1.0 CAUTION

- Ensure you are using your Dash Camera within your countries' road laws. Please make sure you are familiar with your local road legislation before use.
- Avoid leaving your Dash Camera in direct sunlight for extended periods of time in an unventilated space.
- Please set up the time and date before you use this device to record.
- The notifications given by the Dash Camera are suggestions only, please drive to the actual conditions.
- The results of GPS positioning are for reference only. The Dash Camera will lose GPS positioning abilities when signal is blocked (e.g. driving through tunnels, enclosed car parks).
- GPS positioning accuracy may vary depending on weather and surroundings such as dense cities, tunnels, or forests. GPS satellite signals cannot pass through most solid materials. Tinted windows may also affect the GPS signal.
- The values displayed in this system, such as speed, position, and the distance warning, may be affected by the surrounding environment.
- The system is to be used only for non-commercial use, within the limits permitted by your countries' relevant laws.

- Avoid using the Dash Camera near any devices that emit radio interference (e.g. microwave ovens).
- It is considered normal operation for the Dash Camera to get warm during use.

1.1 BATTERY WARNING

Always power the Dash Camera using the provided charger. Improper charging of the Dash Camera and may result in failure of the internal battery.

Never dismantle the Dash Camera or expose the internal battery.

Do not dispose of the Dash Camera in fire.

Dispose of the Dash Camera observing local regulations and being mindful of the internal battery.

Do not attempt to replace or expose the internal battery.

NOTES ON INSTALLATION

- It is advised that the Dash Camera is installed near the rear view mirror, at the top centre of the windshield for optimal operation.
- Make sure that the lens is within the range of the windscreen wiper to ensure a clear view when it rains.
- Do not touch the lens with your fingers. Fingerprints left on the lens will result in unclear videos or photos. If photos or videos are blurred, please clean the lens gently with a microfibre cloth.
- Do not install the device on a tinted window. Doing so may damage the tint film and restrict the Dash Camera's GPS signal
- Make sure that the installation position does not hinder or block the field of view or GPS signal.
- Only use the included cable to power the Dash Camera.
- The KPT-590GPS is designed to be constantly connected to the included power supply, and is NOT designed to be used solely with the camera's built-in battery.

1.2 PRODUCT INFORMATION

For the latest manual and product updates please visit our website at www.kapturecam.com.au or www.kapturecam.co.nz

2.0 INTRODUCTION

Thank you for purchasing a Kapture Dash Camera. Please read through the instructions before attempting to install or use this product.

This User Guide is designed to assist with the day to day operation of the KPT-590GPS.

Before attempting to use or install your Kapture KPT-590GPS, please ensure you have read and understood all of the safety notes below.

- Do not expose your KPT-590GPS to liquids, excessive dusty conditions or temperatures exceeding 60°C.
- Only use the included cables to power and charge the KPT-590GPS.
- Please do not attempt to adjust the KPT-590GPS position or settings whilst you are driving your vehicle.
- Please clean the windshield thoroughly removing all dust and dirt particles before fixing the adhesive mount.
- Since the mount sticks on the windshield with the 3M mount, please ensure that the position of the camera is best located to capture the maximum area.

- We suggest you power-on the Dash Camera and test the playback image on screen first prior to removing the 3M tape for installation.
- Only remove the 3M tape when you are satisfied that the Dash Camera placement and image position are delivering the best possible image and view of the road ahead.
- Ensure you are using your KPT-590GPS within your countries' road laws. Please make sure you are familiar with your local road legislation before use.

2.1 PACKAGE CONTENTS



KPT-590GPS
Dash Camera



3M GPS Mount



Car Charger



Spare 3M
Adhesive



User Guide



Electrostatic
Film x 1

2.2 PRODUCT OVERVIEW

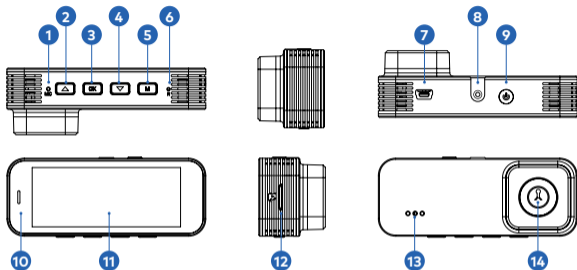

1. Microphone
2. UP button (also ON/OFF audio)
3. REC/OK button
4. DOWN/LOCK button
5. MENU/MODE button
6. Reset
7. Mini USB Power Socket

8. Slot for affixing mount
9. ON/OFF Power button
10. Recording LED Indicator
11. Display Screen
12. Micro SD card slot
13. Speaker
14. Lens

3.0 BUTTON FUNCTIONS

MENU & MODE BUTTON

When the device is not recording, press the M button to switch between Video Mode / Photo Mode / Play Back Mode.

Press and hold the 'M' button to enter into the KPT-590GPS menu settings.

OK BUTTON

Press the OK Button to start/stop video recording in Video Mode. (Please note, when connected to power and in Video Mode, the KPT-590GPS will automatically start recording).

Press the OK Button to take a photo in Camera Mode.

Press the OK Button to play/pause the current video in Playback Mode.

POWER BUTTON

Press and hold the Power Button to Power Off the Device. Press once to switch the LCD Screen OFF, however the Dash Camera will continue recording.

LOCK & DOWN BUTTON

In the Settings menu use the down key to toggle between settings.

While the Dash Camera is recording, press the 'Lock' button to lock the current file. Locking a file will prevent it from being recorded over during loop recording.

▲ UP BUTTON

In the Settings menu, use the Up button to toggle between settings.

Press the 'Up' button to turn the inbuilt microphone ON/OFF.

R RESET BUTTON

Press to reset to factory settings.

MIC MIC

Microphone Position

TF TF CARD SLOT

Micro SD Card Slot. Please use Maximum 32 GB, Class 10 and above.

USB USB INTERFACE

Mini USB socket to connect with power cable provided.

4.0 GETTING STARTED

4.1 INSERTING A MICRO SD CARD

With the Dash Camera turned off and the screen facing towards you insert your Micro SD Card (not included) in the slot on the right side of the KPT-590GPS with the text on the Micro SD card away from you. Push the memory card in until a click is heard.

4.2 REMOVING A MICRO SD CARD

Ensure that the KPT-590GPS is powered off, and with your thumbnail press in the Micro SD Card until a click is heard. The Micro SD Card will eject from the KPT-590GPS when released.

NOTE:

- Micro SD Card is not included.
- Do not remove or insert the Micro SD card while the Dash Camera is turned on as this may damage the Micro SD card or corrupt the memory cards' stored data.
- Please use a Class 10 or higher rated Micro SD card with a maximum capacity of 32GB.
- Please format the Micro SD card before the initial use. (See section 6.1 for instructions on Formatting your Micro SD card).
- When removing the Micro SD card, be careful as the card may eject quickly.

4.3 INSTALLING THE KPT-590GPS

1. Connect the window mount to the top of the Dash Camera and rotate the locking nut (See Fig 1 on **page 14**) clockwise until it is tight.
2. Please follow the instructions on **page 6** before continuing.
3. Remove the protective stickers from the Dash Camera and the Suction Mount.
4. Press the mount base firmly against the windscreen and hold for 30 seconds.
5. Insert the power cable adapter into the Dash Camera power socket.

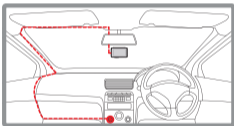

(Fig .1) Installing the KPT-590GPS

NOTE:

- It is advised that the KPT-590GPS is installed in the centre of the windscreen behind the rearview mirror.

4.4 INSTALLING THE KPT-590GPS MOUNT

1. **3M Tape** - Please remove the 3M tape and place the mount onto your windscreen.
2. **Release lever** - Use this lever to release your Dash Camera and GPS mount from the windscreen mount.
3. **Power Socket** - Please insert your 12V power adapter cable into this socket to power the GPS mount unit.
4. **Angle Locking Wheel** - Loosen the angle locking wheel on the mounting bracket to adjust the vertical and horizontal angle of your Dash Camera. Tighten the angle locking wheel once your Dash Camera position has been selected.
5. **Dash Camera Mounting Lock** - Insert this into your Dash Camera's mounting hole and tighten the lock once your Dash Camera has been mounted.
6. **Dash Camera Power Connection** - Please insert this cable into your Dash Camera's USB Socket on top. This will power your dash camera for use.



NOTE

- When removing the GPS Mount from your windscreen, please gently twist the module bracket to the left (unlocked) position until the 3M tape and bracket become loose from the windscreen.

4.5 CONNECTING TO POWER

Only use the included charger to power and charge the Dash Camera.

1. Once the Dash Camera is securely installed on your vehicle's windscreen, plug the DC Power Plug into your vehicle's cigarette lighter.
2. Run the power cable along the top and side of the windscreen and behind your glove box. Plug the Mini USB plug into the Dash Camera and the DC Power Adaptor into your cigarette lighter port. (See Fig 1 on **page 13.**)

NOTES:

- It is recommended that the Dash Camera is installed behind your vehicle's rearview mirror.
- Make sure that the Dash Camera view is not obstructed by any window tint or any other objects.
- The KPT-590GPS is designed to be constantly powered by the included DC Power Plug. The internal battery is designed to hold saved settings and power the camera when in Park Mode. The battery is NOT designed for primary use.

It is highly recommended you format your Micro SD card the first time it is inserted. Please follow the Micro SD card Formatting instructions on **page 18** Section 6.1.

4.6 LED INDICATOR

- A flashing blue light indicates recording is in progress.
- A constant flashing red light indicates the internal battery is charging.

NOTE:

- The KPT-590GPS is designed to be constantly powered by the included DC Power Plug. The internal battery is designed to hold saved settings and power the camera when in Park Mode. The battery is NOT designed for primary use.

5.0 POWERING THE KPT-590GPS ON/OFF

5.1 AUTO POWER ON/OFF

When the Dash Camera is correctly installed and connected to your vehicle's power supply, the Dash Camera will automatically power up and start recording when the vehicle accessories are activated.

5.2 MANUAL POWER ON

Hold the  Power button on the upper right hand side of the camera until the Kapture start up screen appears.

5.3 MANUAL POWER OFF

Make sure that recording has stopped and then press the  Power button on the upper right hand side of the Dash Camera. After powering down the device, please wait for 10 seconds before turning the Dash Camera back on.

5.4 RE-SETTING THE DASH CAMERA

If the Dash Camera does not function normally, try restarting the Dash Camera. To restart the Dash Camera, using a small pin, press and hold the Reset button on the bottom side of the camera.

6.0 INITIAL SETTINGS

Before using the Dash Camera we recommend Formatting the Inserted Micro SD Card and setting the correct Time and Date.

6.1 FORMATTING THE INSERTED MICRO SD CARD

Formatting the Micro SD card will delete all information on the inserted Micro SD Card and prepare the card for use with the Dash Camera.

1. Press the Button to stop the Dash Camera from recording.
2. Press and hold the Menu Button to enter the Settings Menu.
3. Use the and Buttons to navigate the Settings Menu and highlight the Format setting and press the right to select.
4. Select SD Card and press the Button.
5. Press the Button to confirm.

NOTES:

- Menus cannot be accessed while the Dash Camera is recording. Please stop the recording before attempting to access the menu.
- Formatting your Micro SD Card will delete all files from the card. Once these files have been deleted you will not be able to recover them.

7.0 SETTING THE TIME AND DATE

Setting the Time and Date allows you to stamp your footage with the time and date as a reference. Date and time stamps are important, especially when using your footage in an insurance claim.

1. Press the Button to stop the Dash Camera from recording.
2. Press and hold the Button to enter the Settings Menu.
3. Use the and Buttons to navigate the Settings Menu and highlight the Date/Time setting and press the right Button to select.
4. Use the and Buttons to edit the selected digit and the right button to confirm and progress to the next digit. The final field will set the format that the date will be presented in, and pressing the button with this field highlighted will save the date and revert to the settings menu.

NOTES:

- Menus cannot be accessed while the Dash Camera is recording. Please stop the recording before attempting to access the menu.
- Once the time and date is set, it can be stamped onto your footage using the Date Stamp setting.

8.0 VIDEO MODE

When the Dash Camera is powered ON the video screen will start by default. In this screen, recording will automatically start and can be stopped by pressing the Button. To access the Video Menu, ensure that the Dash Camera is not recording then press and hold the button.

9.0 INTERFACE

9.1 VIDEO MODE







1. **Video Mode:** Number 2 shows the loop recording duration in minutes.
2. **Resolution:** 1080 FHD Video Recording Resolution .
3. **Duration:** 00:00:01 Loop Recording timer and also indicates if the Dash Camera is recording when highlighted red.

4. **Date:** (01/01/2021)
5. **Time:** (00:00:01)
6. **Motion Detection:** Displays Motion Detection.
7. **G-Sensor:** The highlighted bar indicates the sensitivity of the G-Sensor with 1 Bar indicating Low Sensitivity.
8. **Micro SD Card:** Indicates inserted Micro SD Card.
9. **Battery:** Indicates battery level.
10. **Microphone:** Turns on or off the Microphone.
11. **Recording Start/Pause Button:** Press this button if you want to manually record, or pause the recording.
12. **Lock File:** Current Recorded File Locked indicator.
13. **Menu Operation Button:** Press and hold to access the menu.
14. **License Plate:** Will show your License Plate and stamp your footage with your License plate details.

9.2 SETUP MENU

1. Press to stop Recording.

2. Press and hold the  Menu button to enter into the Settings Menu.
3. Press the  and  Button to select the setting you wish to change.
4. Press  Button on your selected option.
5. New Setting will be shown on the top left of the screen and also on the selected setting icon.

10.0 VIDEO MENU

Menu	Select Settings	Description
Resolution	1080P FHD 720P FHD	Please note, higher resolution gives your footage more detail but uses more storage space. Lower resolution saves storage space. Default: 1080P
Loop Recording	Off / 1, 3 or 5 Minutes	Loop Recording defines the length of time the KPT-590GPS records before creating a new file. Using the Off setting will record the longest possible loops under the file size of 1 GB (around 5 minutes). Default: 3 Mins

VIDEO MENU CONT'

Menu	Select Settings	Description
Photo Resolution	12M 4032 x 3024 8M 3264 x 2448 5M 2592 x 1944 2M 1920 x 1080	Higher resolution gives your footage more detail but uses more storage space. Lower resolution saves storage space. Default: 12M
Language	Select Language	Select Menu Language. Default: English
Date/Time	Set Date and Time	Using the Up/Down and OK buttons to enter the date and time (24hr clock) to stamp onto your footage. Once you have finished use the Menu button to save and return to the Settings Menu.
G-Sensor	Off / Low / Medium / High	To adjust the sensitivity of the G-sensor. High is the highest sensitivity and Low is the lowest. Default: Low

VIDEO MENU CONT'

Menu	Select Settings	Description
Parkmode	Off / Low / Medium / High	Parkmode helps to make your car safe by recording video even when the engine is switched off. Your Dash Camera will record incidents whenever it detects an impact and the G-Sensor is triggered. Parkmode will record a maximum of 10 instances during a 24 hour period, once the battery has been fully charged. Default: Off
Motion Detection	Off / On	The Dash Camera will stop recording if it doesn't detect any motion and will immediately start recording if it detects motion. Default: Off
Number Plate Stamp	Input Number Plate	Input your car number plate and it will be stamped on the recorded footage.
Date Stamp On	Off / On	Select On/Off to have the date and time stamped on the recorded Video. Default: On

VIDEO MENU CONT'

Menu	Select Settings	Description
Microphone	Off / On	Turning this setting off mutes the built in microphone. Default: On
Beep sound	Off / On	Mutes control for Key beeps. Default: On
Auto Display Off	Off / 1 min / 3 mins / 5 mins	Auto Screen Saver setting determines the amount of time before the display screen turns off. (KPT-590GPS will keep on recording even when the display is Off). Default : Off
Flicker	50Hz / 60 Hz	Screen Hz setting. Default: 50 Hz
Format	Cancel / OK	Format the inserted Micro SD Card, deleting all photos, videos and data.

VIDEO MENU CONT'

Menu	Select Settings	Description
Default Setting	Restore factory settings	Cancel / OK
Version	OK	Displays the installed firmware version.

11.0 PICTURE MODE



1. Press OK to Stop Recording.
2. Press M (Mode Key) once to enter Picture Mode.
3. Press OK Key to take pictures.

12.0 PLAYBACK

Video Play/
Pause

File Name



Battery

1. Press the OK Button once to Stop Recording.
2. Press M (Mode Key) twice to enter Playback Mode.
3. Press and button to select the desired file to be played back.
4. Press the OK button to Playback the selected video file and then press again to pause.

13.0 SOFTWARE PLAYBACK

The GPS Add-On unit will record your vehicle's speed and GPS location for playback alongside your footage when viewed on a computer.

To play back the GPS footage, download the player from www.kapturecam.com.au and run it on your PC. (Search our website for KPT-590GPS).

To view images from Dash Camera, you will need to remove the Micro SD Card and transfer the files to your computer using a Micro SD Card Slot or compatible USB adapter.

Once files have been transferred to your computer, please select the folder and select the file you wish to view or playback.



14.0 WARRANTY TERMS & CONDITIONS

Our goods come with guarantees that cannot be excluded under the Australian Consumer Law. You are entitled to a replacement or refund for a major failure and for compensation for any other reasonably foreseeable loss or damage. You are also entitled to have the goods repaired or replaced if the goods fail to be of acceptable quality and the failure does not amount to a major failure. This warranty is provided in addition to your rights under the Australian Consumer Law.

Directed Electronics Australia Pty Ltd (Directed Electronics) warrants that this product is free from defects in material and workmanship for a period of 12 months from the date of purchase or for the period stated on the packaging. This warranty is only valid where you have used the product in accordance with any recommendations or instructions provided by Directed Electronics.

This warranty excludes defects resulting from alterations of the product, accident, misuse, abuse or neglect. In order to claim the warranty, you must return the product to the retailer from which it was purchased or if that retailer is part of a National network, a store within that chain, along with satisfactory proof of purchase. The retailer will then return the goods to Directed Electronics.

Directed Electronics will repair, replace or refurbish the product at its discretion. The retailer will contact you when the product is ready for collection. All costs involved in claiming this warranty, including the cost of the retailer sending the product to Directed Electronics, will be borne by you.

Ph: +61 03 8331 4800 | Email: info@kapturecam.com.au

14.1 INDEMNITY

You agree to defend, indemnify and hold harmless Kapture and its subsidiaries and affiliates from and against any and all claims, proceedings, injuries, liabilities, losses, costs and expenses (including reasonable legal fees), including but not limited to, claims alleging negligence, invasion of privacy, copyright infringement and/or trademark infringement against Kapture and its subsidiaries and affiliates, relating to or arising out of your breach of any provision of these terms, your misuse of Kapture products or its services, or your unauthorised modification or alteration of products or software.

14.2 WARRANTY AND WARRANTY DISCLAIMER

Kapture has a limited warranty, whereby Kapture warrants to you and only to you that this Kapture product will be free from defects in materials and workmanship for one (1) year from the date of your purchase (unless a longer warranty period is required by law). The specifics of this Kapture limited warranty are covered in this manual. In addition to the standard one (1) year warranty offered, an additional one (1) year warranty, under the same Terms & Conditions prescribed, is available if your product is successfully registered on the official Kapture website (<https://www.kapturecam.com.au/2-year-warranty/>).

To the extent possible under governing law, other than the above product warranty for the Kapture product you understand and agree that the Kapture products and services are provided on an "as is" and "as available" basis. Kapture makes no warranty that the Kapture products and services will meet your requirements or that use of the Kapture products and services will be uninterrupted, timely, secure or error-free. Nor does Kapture make any warranty as to the accuracy or reliability of any information obtained through Kapture (including third party content), that any defects in the Kapture products or services be corrected or that the Kapture products or Kapture services will be compatible with any other specific hardware or service. Further, Kapture does not warrant that Kapture products or services or Kapture servers that provide you with data and content are free of viruses or other harmful components. Kapture also assumes no responsibility for and shall not be liable, for any damages caused by viruses that may infect your Kapture product or software.

In the event of any loss, damage or injury, you will not look to Kapture to compensate you or anyone else. You release and waive for yourself and your insurer all subrogation and other rights to recover against Kapture arising as a result of the payment of any claim for loss, damage or injury.

Kapture equipment and services do not cause and cannot eliminate occurrences of certain events and Kapture makes no guarantee or warranty, including any implied warranty of merchantability or fitness for a particular purpose or that Kapture equipment and services provided will detect or avert such incidents or their consequences. Kapture does not undertake any risk that you or property, or the person or property of others, may be subject to injury or loss if such an event occurs. The allocation of such risk remains with you, not Kapture. Other than the above product warranty for Kapture products, its suppliers disclaim all warranties of any kind, whether express, implied, or statutory, regarding the Kapture products and services, including any implied warranty of title, merchantability, fitness for a particular purpose, or non-infringement of third-party rights. Because some jurisdictions do not permit the exclusion of implied warranties, the last sentence of this section may not apply to you.

Kapture hereby further expressly disclaims all liability for any claims for service failures that are due to normal product wear, product misuse, abuse, product modification improper product selection or your noncompliance with all applicable federal, state or local laws. This warranty and warranty disclaimer give you specific legal rights, and you may have other rights that vary by state, province, or country.

Other than as permitted by law, Kapture does not exclude, limit or suspend other rights you have, including those that may arise from the nonconformity of a sales contract. For a full understanding of your rights, you should consult the laws of your state, province, or country.

14.3 LIMITATIONS OF KAPTURE LIABILITY

Under no circumstances will Kapture be liable in any way for any content, including, but not limited to, the loss of content, any errors or omissions in any content, or any loss or damage of any kind incurred in connection with use of or exposure to any content posted, emailed, accessed, transmitted, or otherwise made available via Kapture. Kapture liability for damages, especially for breach of duty or obligation, delay in performance, non-performance, or malperformance shall be precluded, except when these are due to negligent breaches of any significant contractual duty or obligation on the part of Kapture. Any liability for negligence is limited to direct losses usually and typically foreseeable in such case. Should the claim for damages be based on wilful or grossly negligent breach of contractual duty or obligation on the part of Kapture, the preclusion and limitation of liability mentioned in the preceding sentences will not Apply. The preceding preclusion and limitation of liability will also not Apply to claims for damages arising out of loss of life, bodily injury or health impacts for which Kapture may be liable, or for non-contractual liability.

Some states and countries do not allow the exclusion or limitation of incidental or consequential damages, so the above limitation or exclusion may not Apply to you. Additionally, this provision is not intended to limit Kapture's liability in the event of Kapture's wilful or intentional misconduct.

15.0 NOTES

YOUR EYEWITNESS ON THE ROAD™

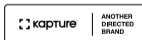

All Images, Information and Content are Copyright © 2023
Directed Electronics Australia Pty Ltd. All Rights Reserved.

www.kapturecam.com.au | www.kapturecam.co.nz

DIRECTED
AUSTRALIA & NZ

www.directed.com.au | www.directed.co.nz